



Telegraph Street, Shipston-On-Stour, CV36 4DA

**SHELDON
BOSLEY
KNIGHT**

LAND AND
PROPERTY
PROFESSIONALS

Property Description

*** DEPOSIT ALTERNATIVE AVAILABLE

AVAILABLE NOW Freshly decorated throughout, ready for a new tenant! This 2 bedroom townhouse is positioned in the heart of Shipston's town centre. With accommodation spread over 3 floors, the ground floor houses a useful utility room and hall cupboard for coats and shoes to be neatly stored away. The first floor includes a Living room with balcony, a kitchen with fridge, oven, hob, pantry and storage cupboard in addition to a WC. The second floor offers a bathroom and 2 bedrooms, both with built in wardrobes. Externally, there is a small fore and rear garden, a garage and driveway parking for 1 car. This home has been freshly decorated and is offered unfurnished. Council Tax Band B. Energy Rating D.





Key Features

- *** DEPOSIT ALTERNATIVE AVAILABLE ***
- AVAILABLE NOW
- Shipston on Stour
- 2 Bedroom, Semi-detached townhouse
- Unfurnished
- Small Fore & Rear Gardens
- Garage & Driveway
- Council Tax Band B
- Energy Rating D
- Freshly decorated throughout

£975 PCM

First Floor

Approx. 32.8 sq. metres (353.1 sq. feet)



Second Floor

Approx. 32.8 sq. metres (353.1 sq. feet)

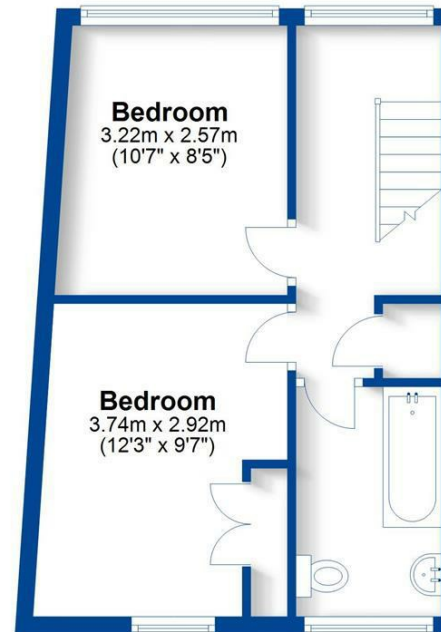

Ground Floor

Approx. 23.1 sq. metres (248.5 sq. feet)

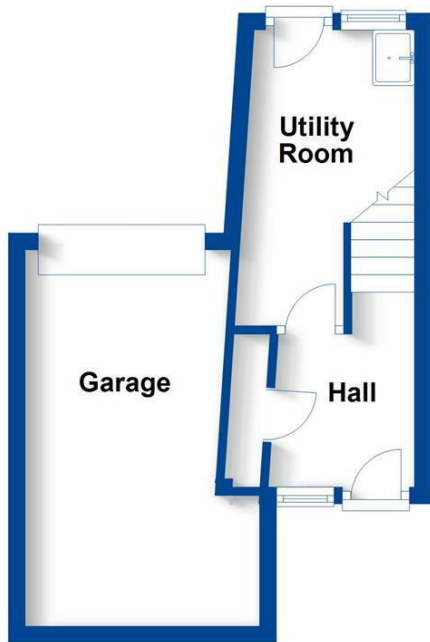

Total area: approx. 88.7 sq. metres (954.7 sq. feet)

This plan is for illustration purposes only and should not be relied upon as a statement of fact
Property of Sheldon Bosley Knight Limited. Not to be reproduced